

Installation Instructions

BHPA100 Bed Head Protector (All Options)

Data Sheet: Page 1 of 2 DW November 2024

BHPA100 Bed Head Protectors can be installed in 4 different formats:

- Option 1 – BHPA1001 Aluminium retainer fixed directly to the wall
- Option 2 – BHPA1002 Retainer standing off the wall using rubber spacers (WGRS25)
- Option 3 – BHPA1003 Retainer standing off the wall using PVC-u extender brackets (BHPA1003/BRKT)
- Option 4 – BHPA1004 Retainer standing off the wall using metal extender brackets (BLXB2)

Important: Prior to installation, ensure that the wall/substrate can support the products/fixings being used.

Follow the instructions below for all options, selecting the correct instructions at point 5 for the installation option being used.

1. Refer to 'Positioning the End-cap'; butt up each end-cap complete with reveal to the retainer, with a 6mm drill bit, drill a hole through the centre of the 'solid end-cap tab' along the v-notch carrying the hole position through the aluminum retainer to accommodate the bolt position for each end-cap. Insert the bolt through the back of the retainer through the end-cap tab and secure with the flanged nut.
2. Use a 6mm drill bit to make 2 holes along the v-notch in the centre of the aluminium retainer at 100mm from both ends of the retainer. These holes can be used for stand-off brackets, spacers or if the protector is to be fitted directly to the wall.
3. Use the 2 holes in the retainer as a template for marking the holes needed to mount the protector, checking with a laser level that the lower holes of each pair of Bed Head Protectors are on the same level. If the BLXB2 extender bracket (Option 4) is to be fitted, use the holes in the retainer as the centre-point datum for marking the 4 holes for the base plate by using a base plate as a template with the 4 holes aligned to the horizontal and vertical of the laser level.
4. For all drilled holes, ensure that appropriate plugs and/or fasteners are used and that there is at least 30mm of threaded fastening length available for the fixing screws (not supplied).
5. Select the appropriate instructions from the following depending on installation option being used:

Option 1 – BHPA1001	Fasten the Protector directly to the wall using appropriate screws.
Option 2 – BHPA1002	With the WGRS25 spacers between the protector and the wall, fasten the protector to the wall using appropriate screws.
Option 3 – BHPA1003	With the BHPA1003/BRKT extender brackets between the protector and the wall, together with the Ø50mm penny washer between the spacer and the protector, fasten the protector to the wall using appropriate screws.
Option 4 – BHPA1004	Ensure that the post of the extender bracket BLXB2 has been fixed to the base plate using the supplied 20mm long countersunk bolts and a 4mm Allen key to properly tighten. Fasten the extender brackets to the wall using appropriate screws. Snap the optional plastic base plate cover onto the base plate. Fix the retainer onto the extender brackets using the supplied 20mm long countersunk bolts and tighten with a 4mm Allen key.
6. Check that the reveals are sitting flush with the end-caps before placing the PVC-u cover on the retainer. Firmly push the PVC-u cover down against the lower reveal while hooking one side of the PVC-u cover on one side of the retainer. Snap the PVC-u cover into place by pushing firmly but slowly on the rounded apex of the PVC-u cover.

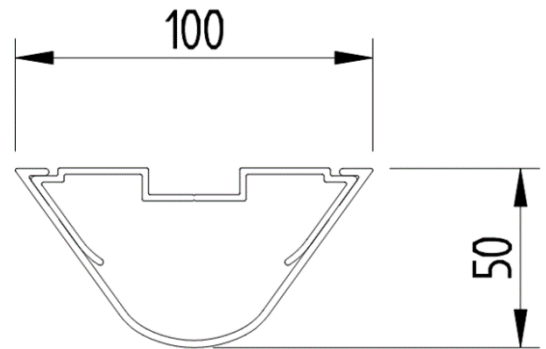

Fitters Tips:

- For custom length bed head protectors which need to be cut on site, the PVC-u cover may try and compress under the pressure of the saw blade during the cutting process. This can be reduced by cutting slowly.
- When fitting several bed head protectors - particularly when utilising the BLXB2 extender brackets (BHPA1004) - it can save time to set-up a template.

BHPA100 Bed Head Protector (All Options)

Data Sheet: Page 2 of 2 DW November 2024

BHPA100 – All Options

Part	Description
WGA1001/XXXX	End Cap (including reveal and fixings)
WGA100A	Aluminium Retainer
WGA100V/XXX	PVC-u Cover
WGRS25	25mm Spacer [Option 2 – BHPA1002]
BHPA1003/BRKT	PVC-u Extender Bracket [Option 3 – BHPA1003]
BLXB2	Metal Extender Bracket [Option 4 – BHPA1004]

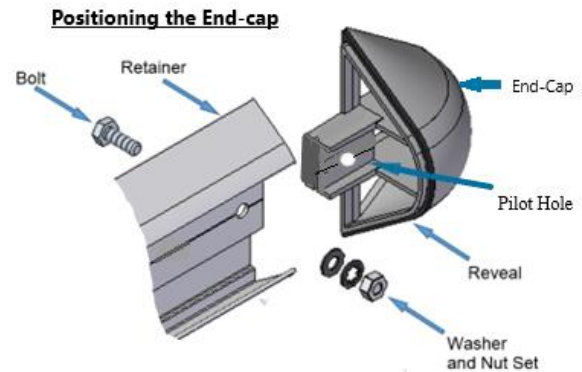

Option 2 – BHPA1002

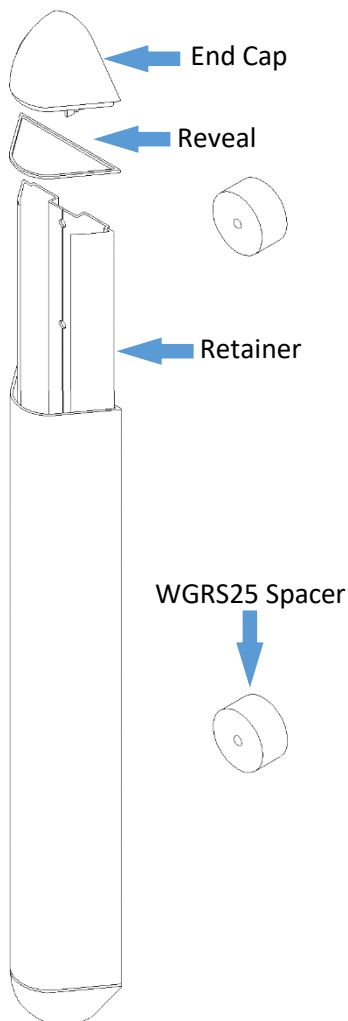

Option 3 – BHPA1003

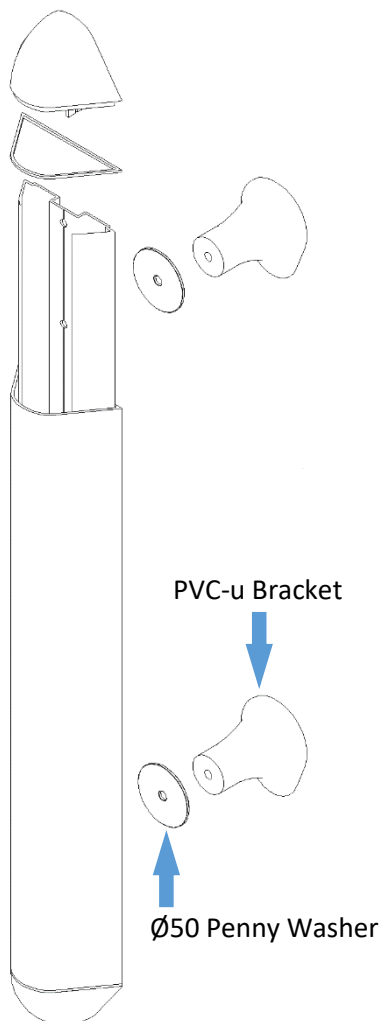

Option 4 – BHPA1004

